

## RLS010 Infra Red Remote Dimmer Switch

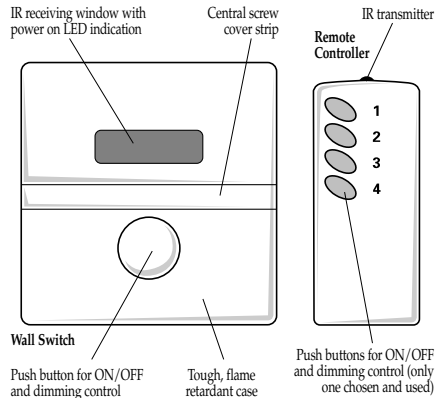

### 1. General

The RLS010 is a standard size replacement wall switch for dimming filament lamps only up to 300W. The light under control can either be switched ON or OFF by a brief press of the push button on the switch itself or on the remote controller.

If either push button is held down after the lamp has turned ON the RLS010 will begin dimming progressively until the correct level is reached and the button is released.

The RLS010 is only suitable for single-way switching applications and cannot be used for two-way switching.

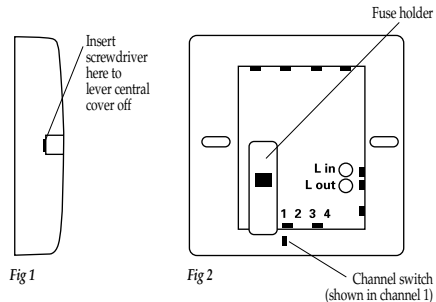

### 2. Installation

#### IF IN DOUBT CONSULT AN ELECTRICIAN.

The RLS010 can be directly mounted on a standard 16mm plaster depth flush box or a standard 16mm surface mount box.

- Remove the central screw cover strip by levering at each end with a screwdriver before pulling the strip away - see fig 1.
- At the rear of the unit (see fig 2) select the channel (1-4) you wish the RLS010 to work on. This determines which of the 4 buttons on the remote controller the wall switch will respond to.
- TURN OFF THE MAINS SUPPLY TO THE SWITCH TO BE REPLACED.**
- Unscrew the fixing screws holding the existing switch to its back box. Pull the switch clear of its back box and remove the two wires from the terminals after loosening the terminal screws.
- Insert these two wires into the screw terminals on the back of the RLS010 marked L in (live supply) and L out (normally red into L in and black to L out). The screws should then be securely tightened. If a metal back box is in use ensure that the cable earth wire is sleeved and connected to the box. If a plastic box is in use ensure that, if the earth wire is loose, it cannot come in contact with the L in or L out terminals.
- By pushing the cable back up the conduit and bending the wires as necessary position the RLS010 over the 2 fixing holes.
- Screw home fixing screws - **do not overtighten.**

### 3. Commissioning

Ensure that the lamp(s) to be controlled are of a suitable type and wattage. Turn on the mains supply to the lamp(s) and RLS010.

Press the push button on the wall switch briefly and the lamp(s) will turn ON, press the button briefly again and the lamp(s) will turn OFF.

If the push button on the wall switch is now pressed and held down the lamp(s) will turn ON and then begin to dim progressively. If the user continues to hold the button down the lamp(s) will dim to a minimum, turn OFF, and then progressively increase in brightness to a maximum. If the button continues to be pressed the brightness will continue to cycle up and down.

To check the remote capability remove battery cover and insert 2 x AAA alkaline batteries in the remote controller being careful to ensure correct polarity (see fig 3). Then using the same number push button as the switch setting in the wall switch repeat the above procedure remembering that there must be a line of sight between the IR transmitter in the remote controller and the receiving window on the wall switch.

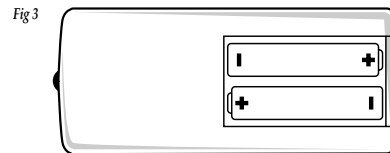

HELPLINE  
020-8450-0515



For a product brochure please contact:  
**Timeguard Ltd.**  
Victory Park, 400 Edgware Road,  
London NW2 6ND  
020-8452-1112  
or email [csc@timeguard.com](mailto:csc@timeguard.com)

#### 4. Operation by remote control

Press the correct button on the remote controller briefly to turn the lamp(s) ON or OFF. Press and hold down this button until the correct brightness is achieved and then release.

#### 5. Operation at the wall switch

Use the push button at the wall switch in the same way as above.

#### 6. Troubleshooting

Symptom	Cause
Power ON LED on wall switch not illuminated	Supply tripped or fuse blown (check lighting ring including RLS010 circuit)  RLS010 fuse blown (check RLS010 lamp circuit)
Push button on wall switch not operative	Lamp failed  Faulty RLS010
Push button on remote controller not operative	Incorrect channel selected at wall switch  Faulty RLS010

#### Specifications

- i Conforms to EC Directives: 73/23/EEC and 89/336/EEC
- ii Permissible Loads: Min 40W Max 300W filament lighting (including halogen)
- iii Operating Ambient Temperature Range: -10°C to 40°C
- iv Operating Voltage: 230V AC 50Hz
- v IR Range: At least 8m up to ±50°, line of sight
- vi Remote Controller Batteries: 2 x AAA Alkaline
- vii Fuse: BS 1362 3A HRC ceramic

**Not suitable for fluorescent low energy and discharge lighting. Also unsuitable for flickering (neon) candle lamps.**

#### 3 Year Guarantee

In the unlikely event of this product becoming faulty, due to defective material or manufacture, within 3 years of the date of purchase, please return it to your supplier with proof of purchase and it will be replaced free of charge.

**Should you encounter any difficulty please contact our helpline on 020 8450 0515.**

## INFRA RED REMOTE DIMMER SWITCH Cat No. RLS010

